

TWILIGHT™

SIGNATURE

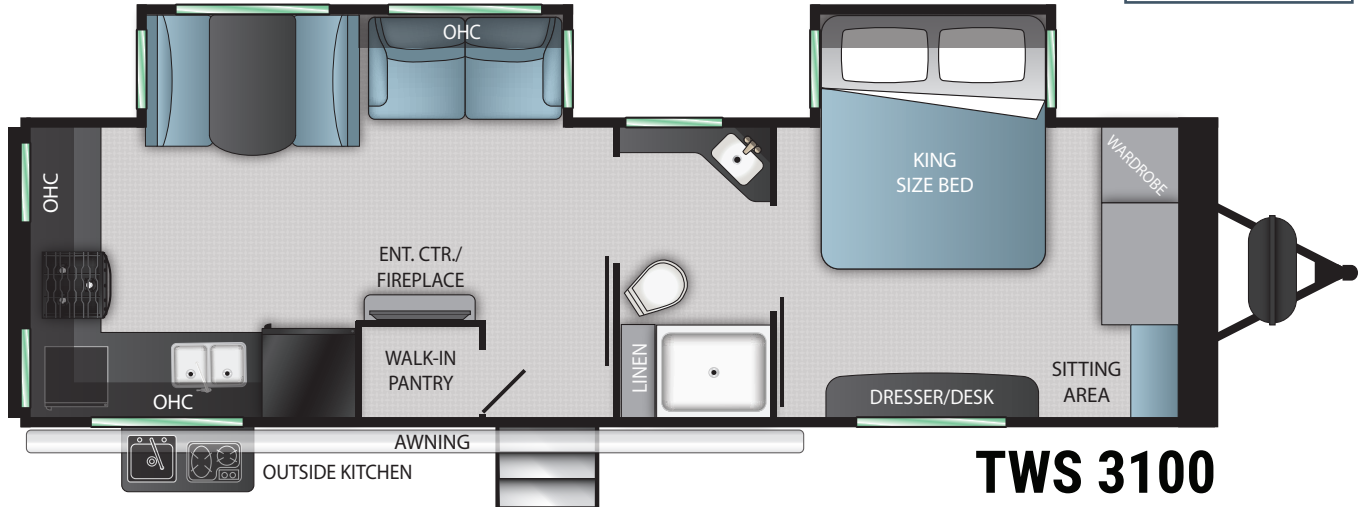

TWS 3100

TOP FEATURES

TWILIGHT SERENITY SUITE

- 72X80 King Size Bed
- True Serta Comfort Mattress
- Dual Nightstands With 110 Power
- Black-Out Roller Shades For Ultimate Privacy
- Adjustable Reading Lights With USB Charging Ports

SAFETY FIRST PACKAGE

- Goodyear Tires With Aluminum Rims
- Spring Axles with 6 Year Warranty
- Rear Ladder With Walkable Roof
- Power Tongue Jack
- Power Stabilizer Jacks

WHOLE RV PROTECTION

- 15000 BTU High performance A/C with Heat Pump
- Whole RV Dual Ducted A/C System
- Insulated Holding Tanks With Forced Heat Protection
- Triple Seal Slide System Technology
- Rain-A-Way Radius Roof Construction

CHEF TECH KITCHEN

- Solid Surface Kitchen Countertops
- Norcold 10 cu.ft. Stainless Steel Refrigerator
- Furrion Gourmet Recessed Oven
- Furrion RV Tested Microwave
- Furrion High Output Range Hood
- Residential High Rise Faucet With Pull Out Sprayer

TWILIGHT ELITE COMFORT

- Dream Dinette Tech System
- Residential Tri-Fold Sofa
- Porcelain Toilet
- 40 LED TV
- Bluetooth Stereo System

TWILIGHT 3100

GVWR	9,434
Dry Weight	7,464
Hitch Weight	634
Dimensions*	8'0" W x 11'2"H x 35'5"
Sleeping Capacity	6
Axles	2
Fresh Tank	44 Gal
Gray Tank	87 Gal
Black Tank	30 Gal
Water Heater	6 Gal
Furnace	30,000 BTU
Air Conditioner	15,000 BTU
Number of Slides	2
Slide Room Height	5'7"
Awning Length	20'
Cook Top	3 Burner
Traditional Oven	YES
Bed Dimensions	72x80 KING

*Overall length defined as tow point (ball coupler for travel trailers / king pin for fifth wheel trailers) to rear bumper. It does not include rear ladder or spare tire. Optional pin boxes will affect overall length. Information provided is accurate as of date of publication and is subject to update & change. Please confirm with your local dealership for up to date information.

www.twilightrvs.com